



Product Warranty



Linear Output Warranty

X-CHROS Monocrystalline BIFACIAL

530 - 535 - 540 - 545 - 550 Wp

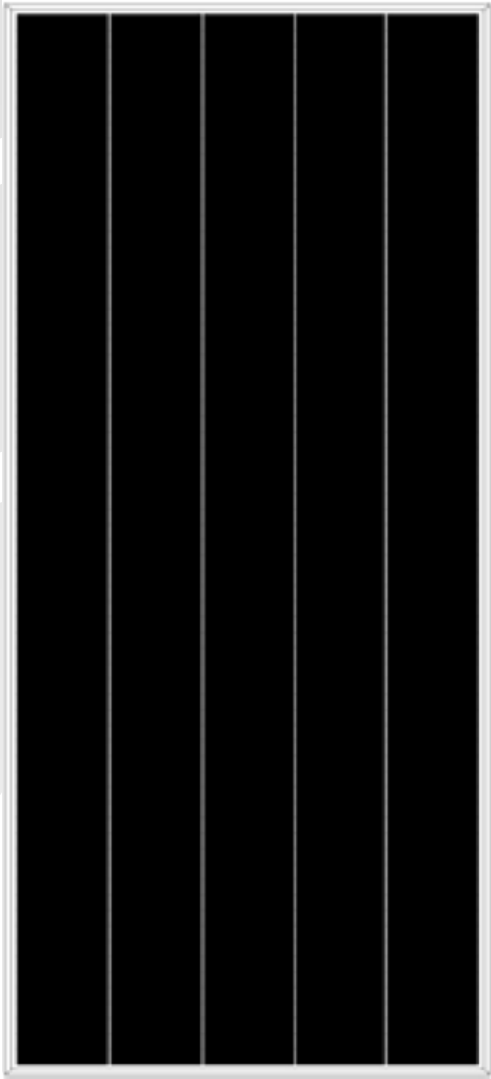

Shingled solar cells



Positive Tolerance



High Voltage 1500 DC



Anti-PID and low LID



21.0 % max efficiency

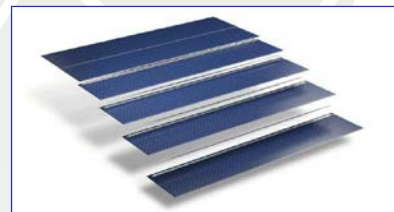

The new photovoltaic modules X-CHROS is one of a wide range of products made by Sunerg and It is manufactured according to IEC 61215, IEC 61730 standard and CE. PERC Shingled Technology provides ultra -high efficiency with better performance in low irradiation. Maximizes installation capacity in limited space

LINEAR WARRANTY

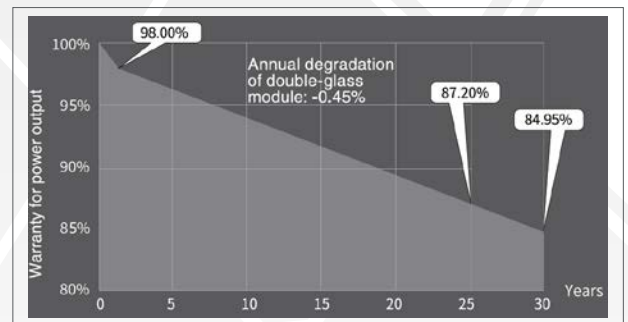

CORRESPOND TO
PV CYCLE | CE |

UNI EN ISO 9001:2008 | Quality management system
UNI EN ISO 14001:2004 | Standards for environmental management system
UNI EN BS OHSAS 18001:2007 | International standards for occupational health and safety

ELECTRICAL DATA (STC)		XMCH116530Q+HBF	XMCH116535Q+HBF	XMCH116540Q+HBF	XMCH116545Q+HBF	XMCH116550Q+HBF
Open circuit Voltage	(Voc)	46.70 V	46.80 V	46.90 V	47.00 V	47.10 V
Voltage a Pmax.	(Vmp)	38.8 V	38.8 V	38.9 V	39.0 V	39.1 V
Short-circuit current	(Isc)	14.55 A	14.65 A	14.76 A	14.86 A	14.97 A
Current at Pmax.	(Imp)	13.67 A	13.79 A	13.89 A	13.98 A	14.07 A
Peak Power (Pmax) Tolerance 0 ~ +5W		530 Wp	535 Wp	540 Wp	545 Wp	550 Wp
Module Efficiency		20.3 %	20.5 %	20.7 %	20.9 %	21.0 %
Maximum voltage		1500 DC	1500 DC	1500 DC	1500 DC	1500 DC
Maximum series fuse rating		30A	30A	30A	30A	30A
Operating Temperature		-40°C - +85°C	-40°C - +85°C	-40°C - +85°C	-40°C - +85°C	-40°C - +85°C

* STC (Standard test conditions)

Irradiance 1000 w/m², module temperature 25°C, AM= 1.5

TEMPERATURE COEFFICIENT

NMOT	42.3°C±2°C
Pmax Temperature Coefficient	-0.34%/ °C
Voc Temperature Coefficient	-0.27%/ °C
Isc Temperature Coefficient	0.04% / °C

MECHANICAL CHARACTERISTIC

Max. surface load capacity (Pa)	front 5400/ back 2400
Dimensions (mm)	2384X1096X30 mm
Weight (Kg)	32 ± 0.3 kg
Encapsulation	EVA
Cells	345 (69*5)

PAKAGING CONFIGURATION

Modules per pallet	36
Modules per container 40'GP	720

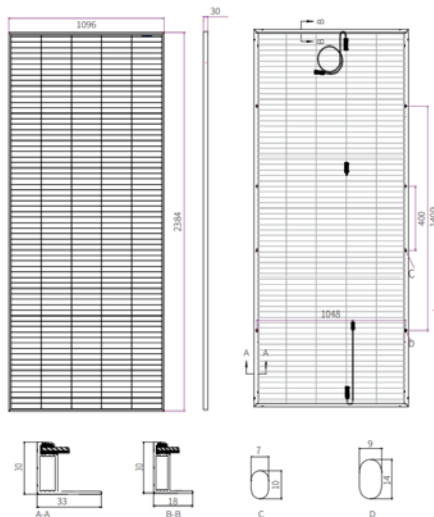

GENERAL INFORMATION

Front Glass	AR coating tempered glass, 2mm
Farne	Anodized Aluminum alloy
Juntion Box	IP68, three diodes
Output Cable - connectors	4mm ² , +500 mm/-1000 mm (vertical) +220mm/-180mm (horizontal)

Sunerg Solar S.r.l. reserves the right to make changes to the technical data of the product without prior notice. The technical details of the form, although included with the utmost care, may contain errors or inaccuracies not attributable to Sunerg Solar S.r.l.